



**Homogenizer
HA36 – Star Line**

MODEL	MAX. POWER	PRESSURE bar			CAPACITY l/h
	kW	1.000	1.200	1.500	
HA36 Star Line	250	5.500	4.500	4.000	

*Values referring to machines with fixed capacity

**Values referring to products with a max viscosity of 500Cp

TECHNICAL DATA

Plunger number	3
Stroke (mm)	140
Weight (kg)	4.800
Water consumption (l/h)	200
Lubrication oil quantity (kg)	40
Connection product inlet/outlet	Flange to weld Øe115 Øi110 / Øe52 Øi46
Max. installed power (kW)	250

Design according to MACHINE DIRECTIVES and the HARMONIZED EUROPEAN STANDARD in force.



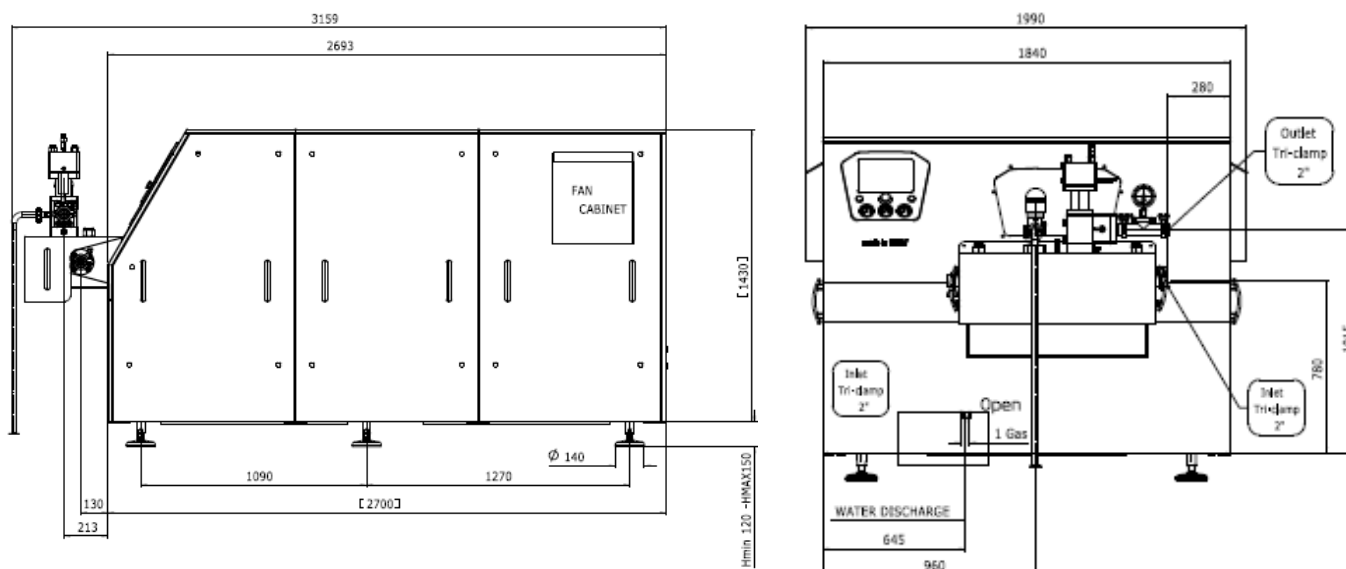

FEATURES

Liquid End: Forged shoot peened mono-block made from Super Duplex SAF2507, 3 Integral Ceramics Plungers, Ultra-High Density plunger seals for very high pressure

Homogenizing group:

- Hydro-pneumatic adjustment of the pressure for a great stability
- Tungsten Carbide Homogenizing valves

Ball type pumping valves, suction and delivery valve seats integrated in a single component

Overpressure valve, flow switch alarm on water circuit

Digital pressure transmitter, 4-20 mA

Drive Unit:

- Forced lubrication system with pressure switch
- Cast iron crankcase with supporting roller bearings
- Double stage transmission system with internal gear reducer with belts and pulleys
- Nitridized crankshaft

Terminal box and control panel for local/remote control

Friendly maintenance of the liquid end

Easy opening panels

Stainless steel frame

MAIN OPTIONS

Second stage homogenizing group

Aseptic execution

- Sterile water generator by means of condensed steam generator
- Patent pending sterile water generator by means of microfiltration

Design suitable with: 3A, EHEDG or PHARMA

- Low roughness and electropolished wetted parts
- Certification manual for cGMP

Standard or Sharp Edge Homogenizing valve with different geometries available in Ceramics

Oil control by means of continuous level sensor (guided wave radar)

Vibration and temperature monitoring and alarm

Inlet and outlet connections:

- DIN 11851, Tri-clamp, SMS
- High pressure outlet
- Option upon request

Electric power board:

- For Fixed or Variable capacity
- Remote Control by 4-20 mA signal
- Fully Automatic pressure control by means of PLC

Sound-proof design

Explosion proof design

