



## Pump model PA33

| MODEL       | MAX. POWER<br>kW | PRESSURE bar |       |       |       |       |       |       | CAPACITY<br>l/h |
|-------------|------------------|--------------|-------|-------|-------|-------|-------|-------|-----------------|
|             |                  | 100          | 180   | 200   | 250   | 300   | 400   | 600   |                 |
| <b>PA33</b> | 45               | 15.000       | 8.000 | 7.500 | 6.000 | 5.000 | 3.500 | 2.500 |                 |

\*Values referring to machines with fixed capacity

\*\*Values referring to products with a max viscosity of 500Cp

### TECHNICAL DATA

|                                 |  |
|---------------------------------|--|
| Plunger number                  | 3  |
| Stroke (mm)                     | 76,2                                       |
| Weight (kg)                     | 1.600                                      |
| Water consumption (l/h)         | 90   |
| Lubrication oil quantity (kg)   | 25   |
| Connection product inlet/outlet | Socket weld flange Øe63.6 Øi56 / Øe38 Øi32 |
| Max. installed power (kW)       | 45   |

Design according to MACHINE DIRECTIVES and the HARMONIZED EUROPEAN STANDARD in force.



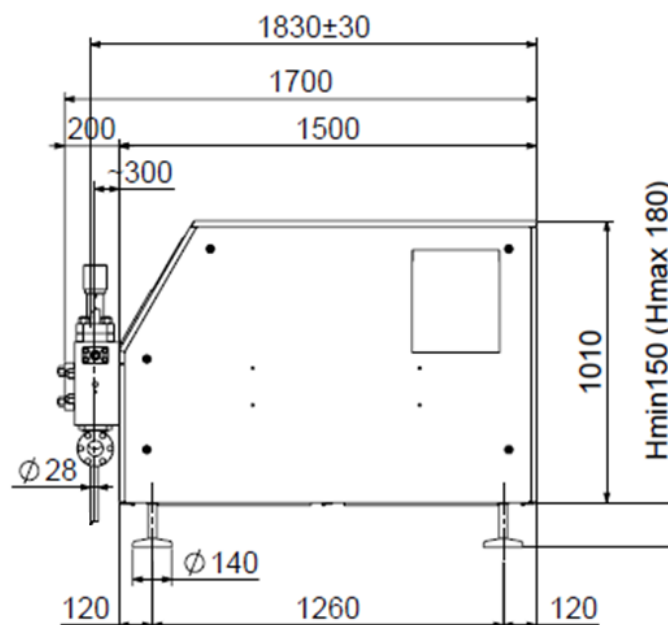
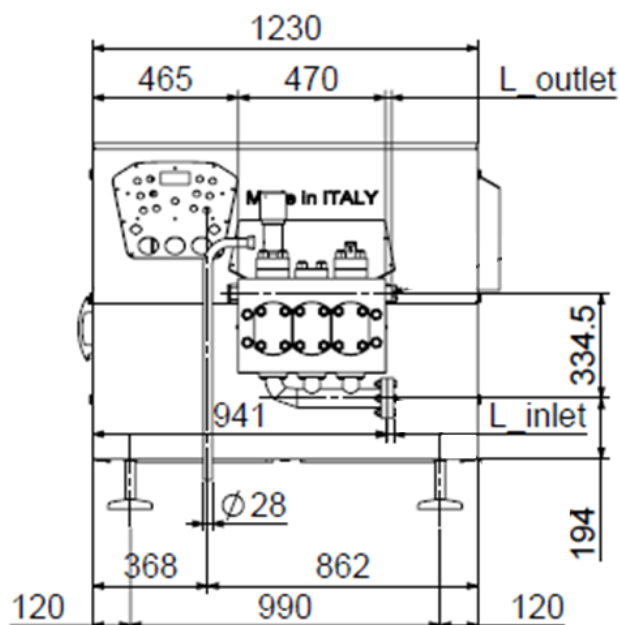

## FEATURES

Liquid End: Forged block made from Duplex SAF2205, Self-alignment patented system, 3 plungers made from A630 with Chromium Carbide coating

Conical valve seats and poppet/ball valves made from Stellite™

Digital pressure transmitter 4-20 mA with ceramic membrane

Overpressure valve, flow switch alarm on water circuit

Drive unit:

- Splash lubrication system
- Die cast iron crankcase
- Nitridized crankshaft
- Direct transmission system with internal gear reducer with belts and pulleys

Terminal box and control panel for local/remote control

Easy opening panels

Friendly maintenance of the liquid end

## MAIN OPTIONS

Aseptic execution

Explosion proof design

Valve seats made from Tungsten Carbide

- Sterile water generator by means of condensed steam generator
- Patent pending sterile water generator by means of microfiltration

Design suitable with: 3A, EHEDG or PHARMA

- Low roughness and electropolished wetted parts
- Certification manual for cGMP

Inlet and outlet connections:

- DIN 11851, Tri-clamp, SMS
- High pressure outlet
- Option upon request

Vibration and temperature monitoring and alarms

Pumping plungers availability:

- A316 with HVOF Chromium Carbide jet coat treatment
- Ceramics

Electric power board:

- For Variable capacity, installable on the machine back side
- Remote Control by 4-20 mA signal
- Fully Automatic pressure control by means of PLC

Sound-proof design

\*\*\*Technical specifications are not mandatory and subject to change without notice.

REV-09/24-EN

